

# TOWN OF OXFORD

## WATERMAIN INFRASTRUCTURE RENEWAL PROJECT MAIN STREET (ELLIS TO JAMES STREET)

### LEGEND: EXISTING

	PAVED ROAD
	ROAD CENTRELINE
	FENCE
	WATERMAIN
	SANITARY PIPE & MANHOLE
	STORM PIPE & MANHOLE
	WATER VALVE
	CURB STOP
	THRUST BLOCK
	FIRE HYDRANT
	POWER POLE
	GUY WIRE
	TREE
	SHRUB
	DRIVEWAY
	CATCH BASIN

### PROPOSED

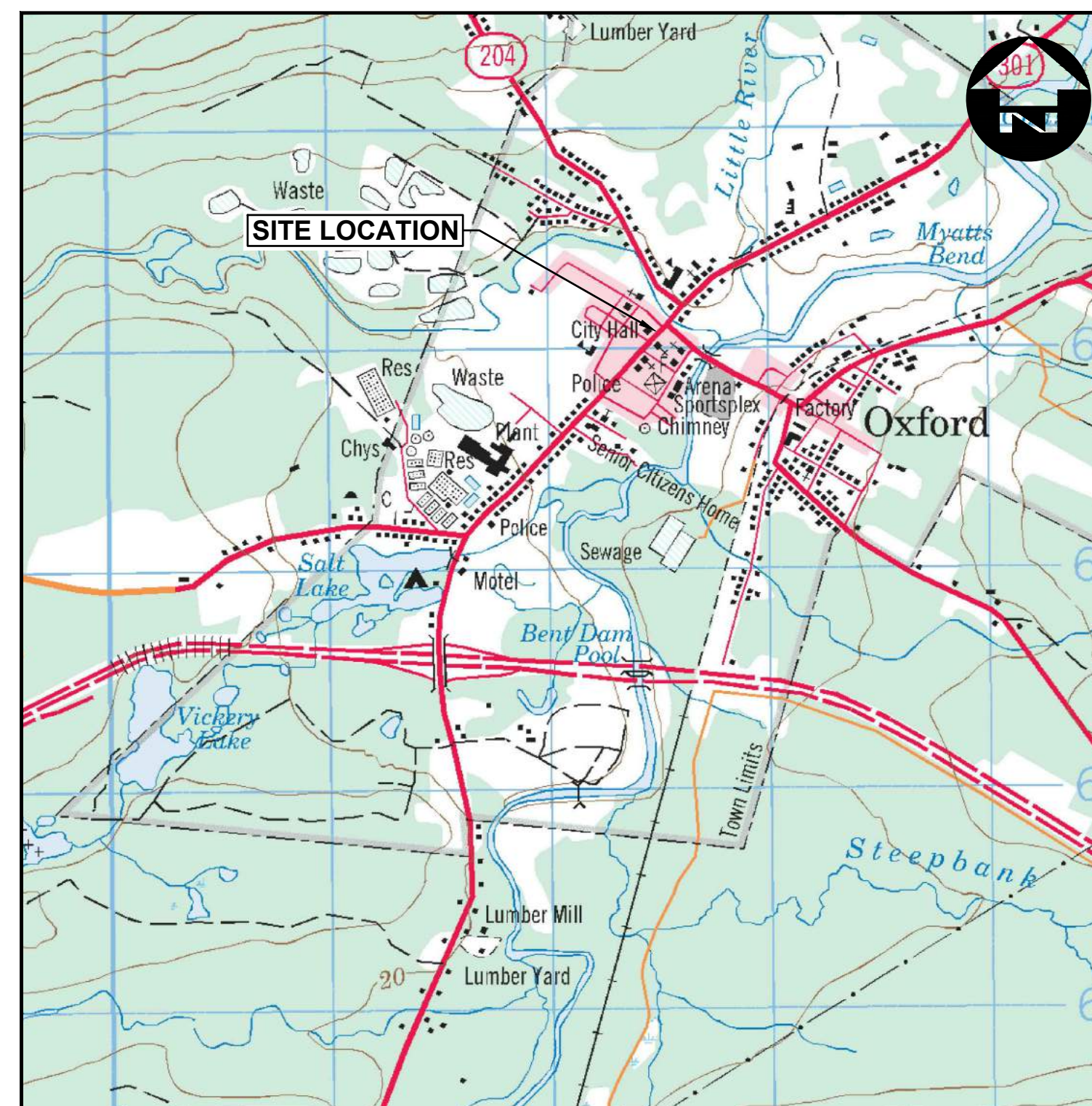
KEY PLAN

DRAWING INDEX	
DWG.	DESCRIPTION
DRAWINGS	
-	COVER SHEET
C101	MAIN STREET PLAN AND PROFILE STA 0+000 TO STA. 0+195
C102	CONNECTION DETAILS
C103	MISCELLANEOUS DETAILS AND NOTES

ISSUED FOR REVIEW  
TENDER No. 2019-02

DILLON PROJECT: 19-9583  
DATE: SEPTEMBER 2019



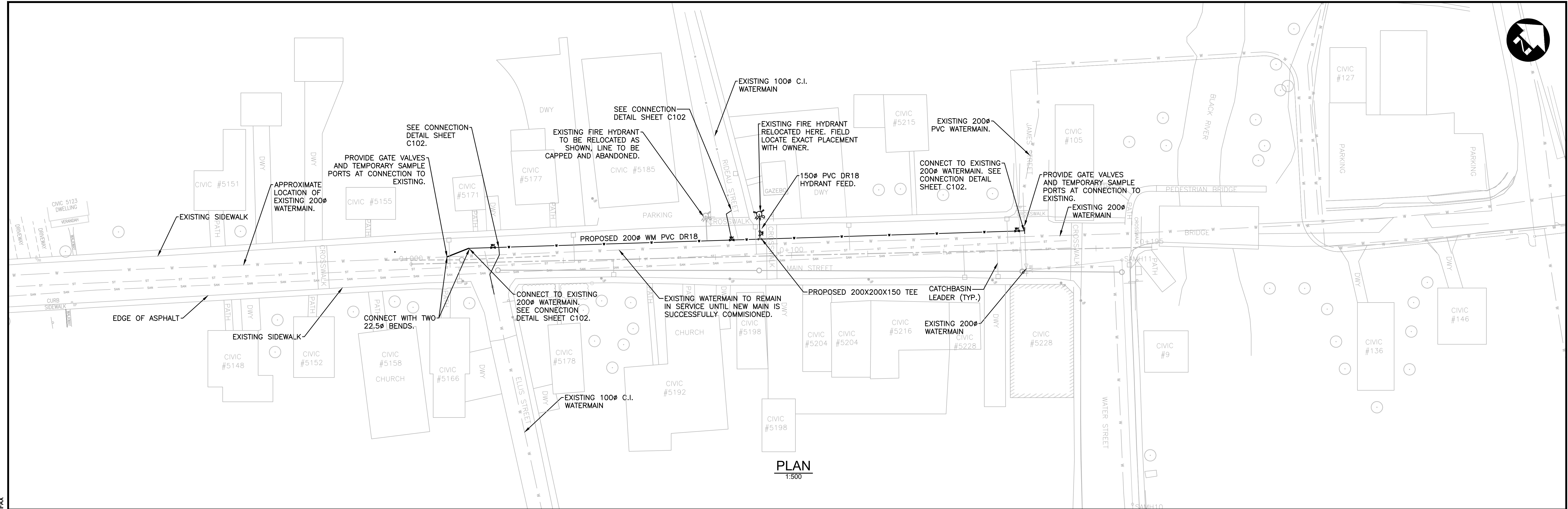

PLAN  
1:500

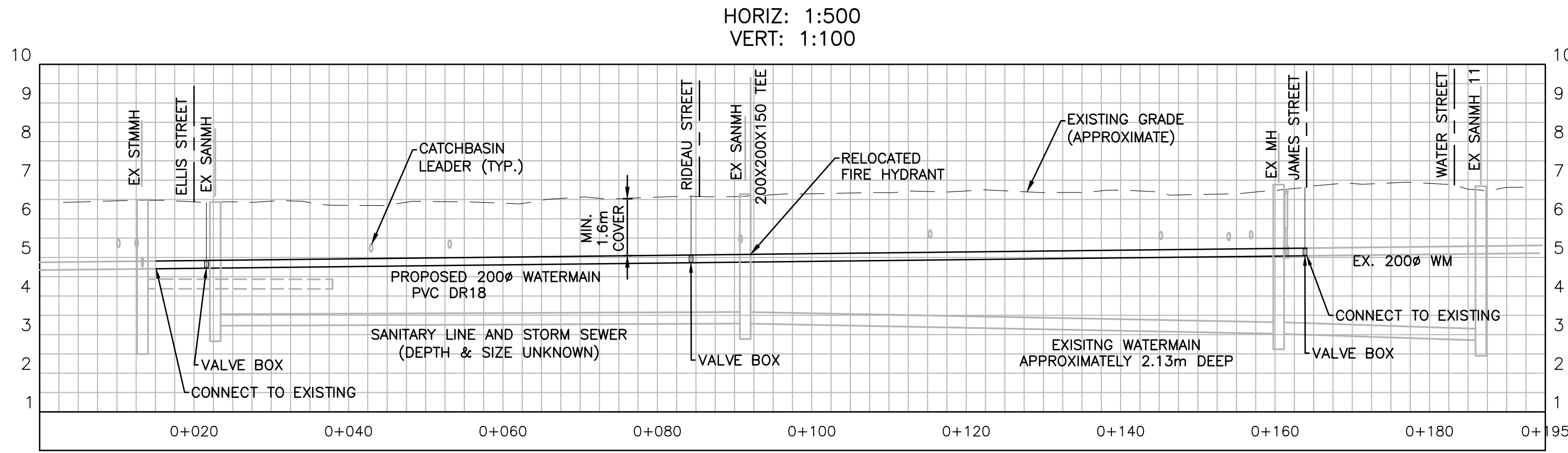

HORIZ: 1:500  
VERT: 1:100

- NOTES:
1. CONTRACTOR TO RECONNECT ALL SERVICES IMPACTED TO NEW 200mm WATERMAIN C/W NEW CURB STOP AND SERVICE TO PROPERTY LINE.
  2. FIELD LOCATE NEW WATERMAIN WITH OWNER PRIOR TO COMMENCING WORK.
  3. ALL DISTURBED SURFACES TO BE RESTORED AND REINSTATED PER SINGLE PIPE TRENCH DETAIL ON SHEET 3
  4. LONG TERM DISRUPTION TO WATER SERVICE IS NOT ACCEPTABLE TO THE OWNER. CONTRACTOR SHALL HAVE INSTALLED/COMMISSIONED NEW WATERMAIN PRIOR TO DISCONNECTING SERVICES OR PROVIDE TEMPORARY WATER SERVICES.
  5. PROVIDE 2-38mm  $\phi$  TEMPORARY SAMPLE PORTS AND CURB STOPS AT CONNECTION TO EXISTING FOR FLUSHING.

FILENAME: C:\PROJECTS\WORKING DIRECTORIES\PROJECTS 2019\SURF\MNS256A1-19583-02-PR-CON-MAIN.DWG PLOTTED BY: WADDEN, RANDY  
 PLOT DATE: 2019-09-08 @ 2:22:47 PM PLOT SCALE: 1:25.4 PLOT STYLE: DILLON-STANDARD.CTB

**Conditions of Use**  
 Verify elevations and/or dimensions on drawing prior to use. Report any discrepancies to Dillon Consulting Limited.  
 Do not scale dimensions from drawing.  
 Do not modify drawing, re-use it, or use it for purposes other than those intended at the time of its preparation without prior written permission from Dillon Consulting Limited.



**NOT FOR CONSTRUCTION**



DESIGN	RTW	REVIEWED BY	KRM
DRAWN	HEB	CHECKED BY	KRM
DATE	JULY 2019		
SCALE	AS NOTED		
No.	1	CLIENT REVIEW	2019/09/05 KRM
		ISSUED FOR	DATE BY

WATERMAIN INFRASTRUCTURE RENEWAL PROJECT		PROJECT NO. 19-9583
<b>MAIN STREET PLAN AND PROFILE STA. 0+00 TO STA. 0+195</b>		SHEET NO. <b>C101</b>

NOTES:

1. CONTRACTOR TO DAYLIGHT CONNECTIONS AND CONFIRM LOCATION OF EXISTING PRIOR TO INSTALLATION. NOTIFY ENGINEER OF ANY DISCREPANCIES.
2. WHERE WATERMAIN CROSSES SANITARY OR STORM SEWER, WATERMAIN TO BE ENCASED IN CONCRETE PER PROVINCIAL STANDARDS.

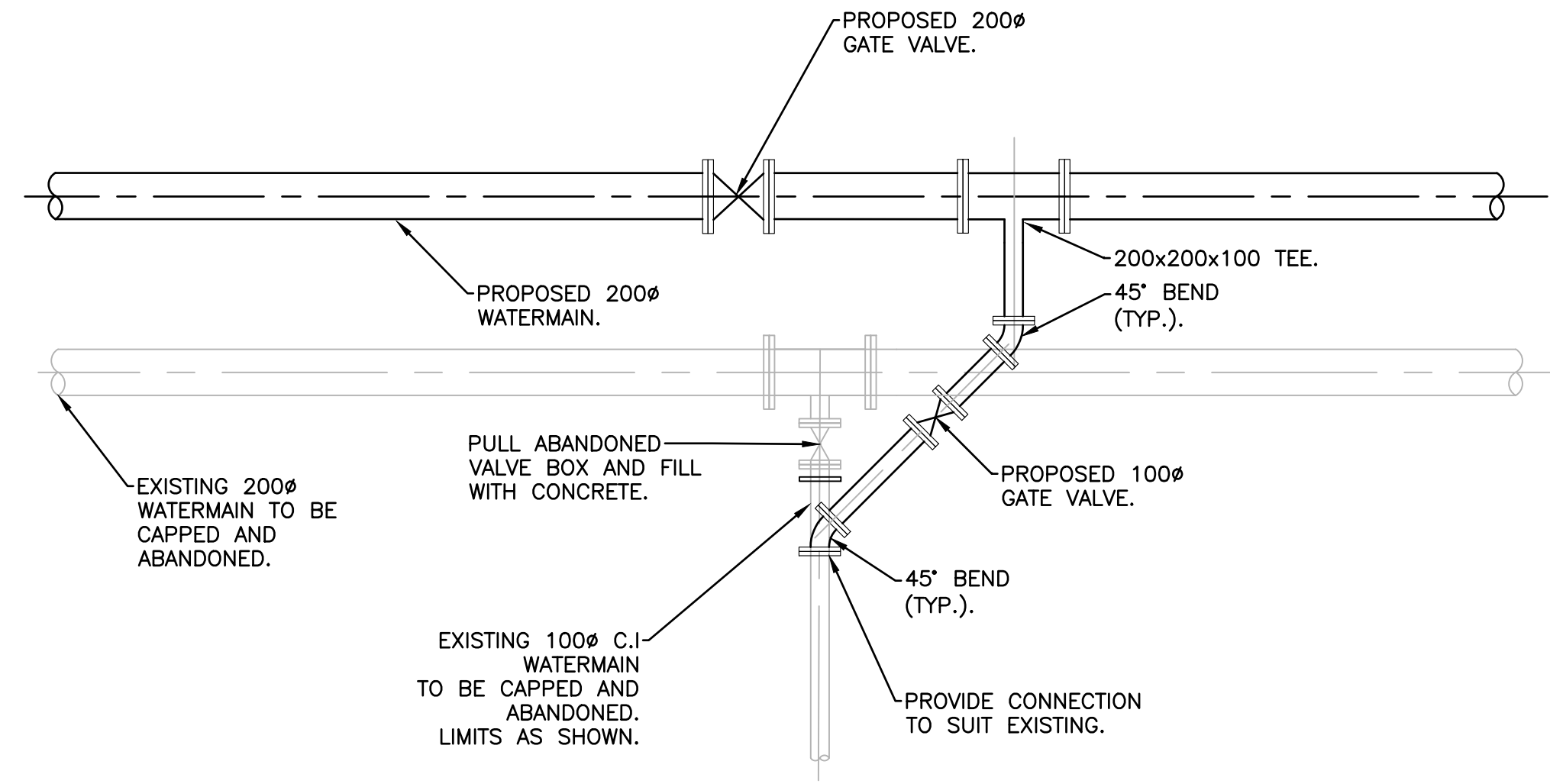

**MAIN & ELLIS STREET CONNECTION DETAIL**  
1:25

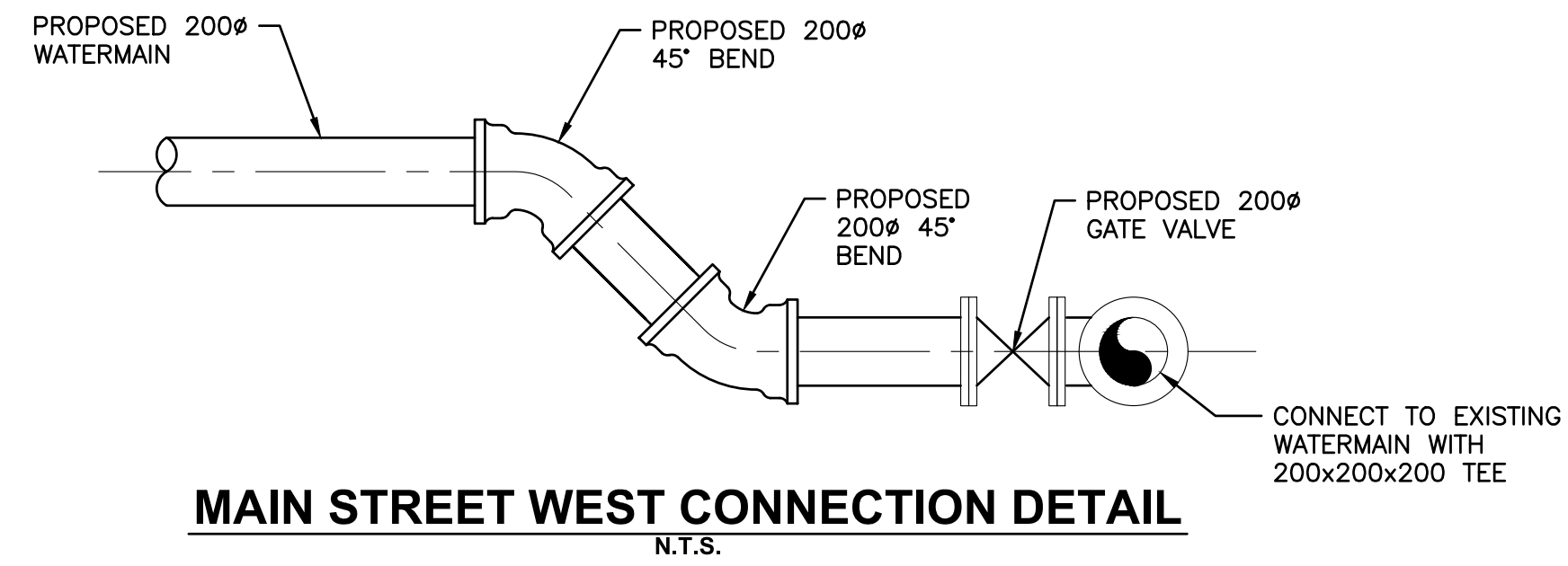

**MAIN STREET WEST CONNECTION DETAIL**  
N.T.S.

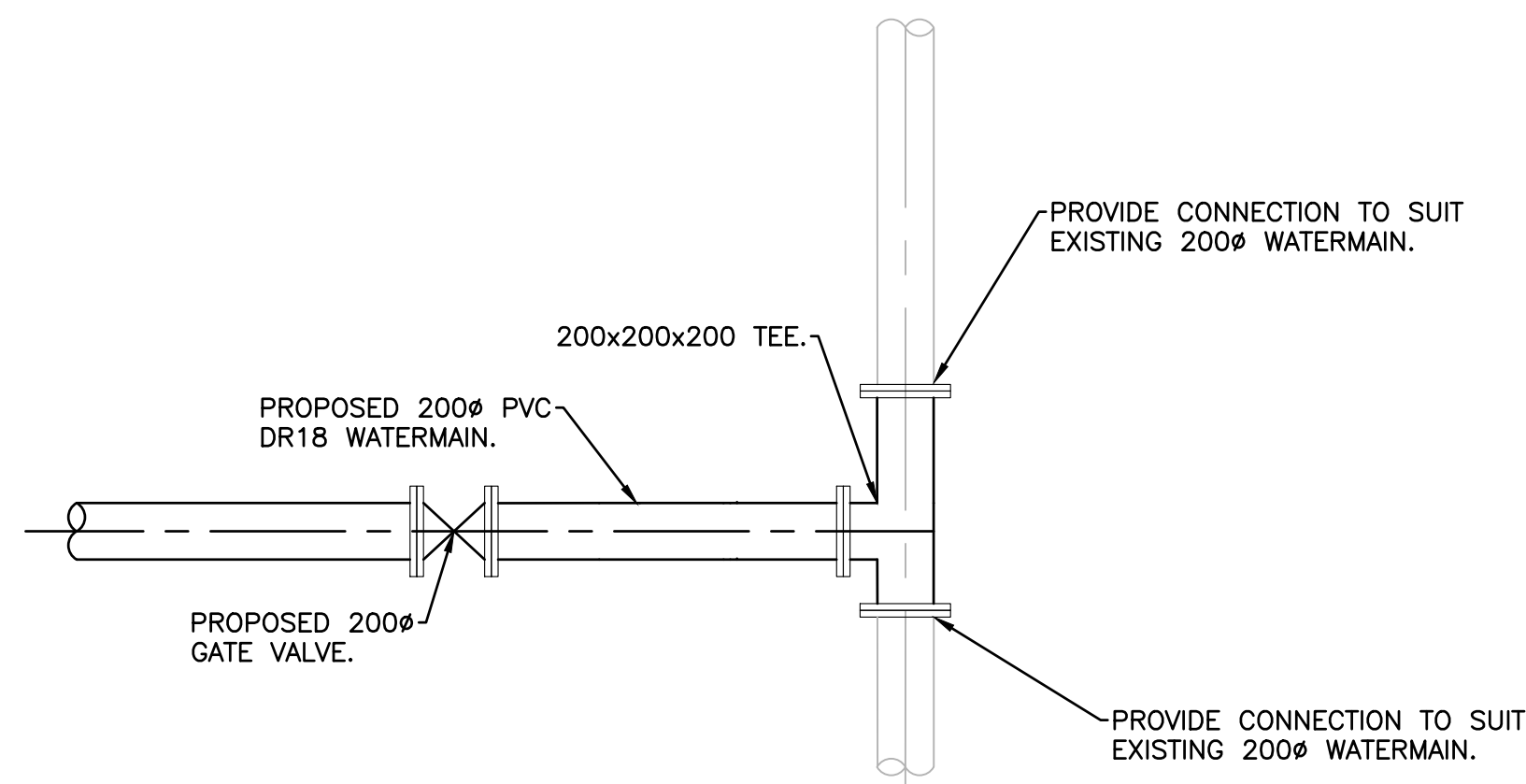

**MAIN & JAMES STREET CONNECTION DETAIL**  
1:25

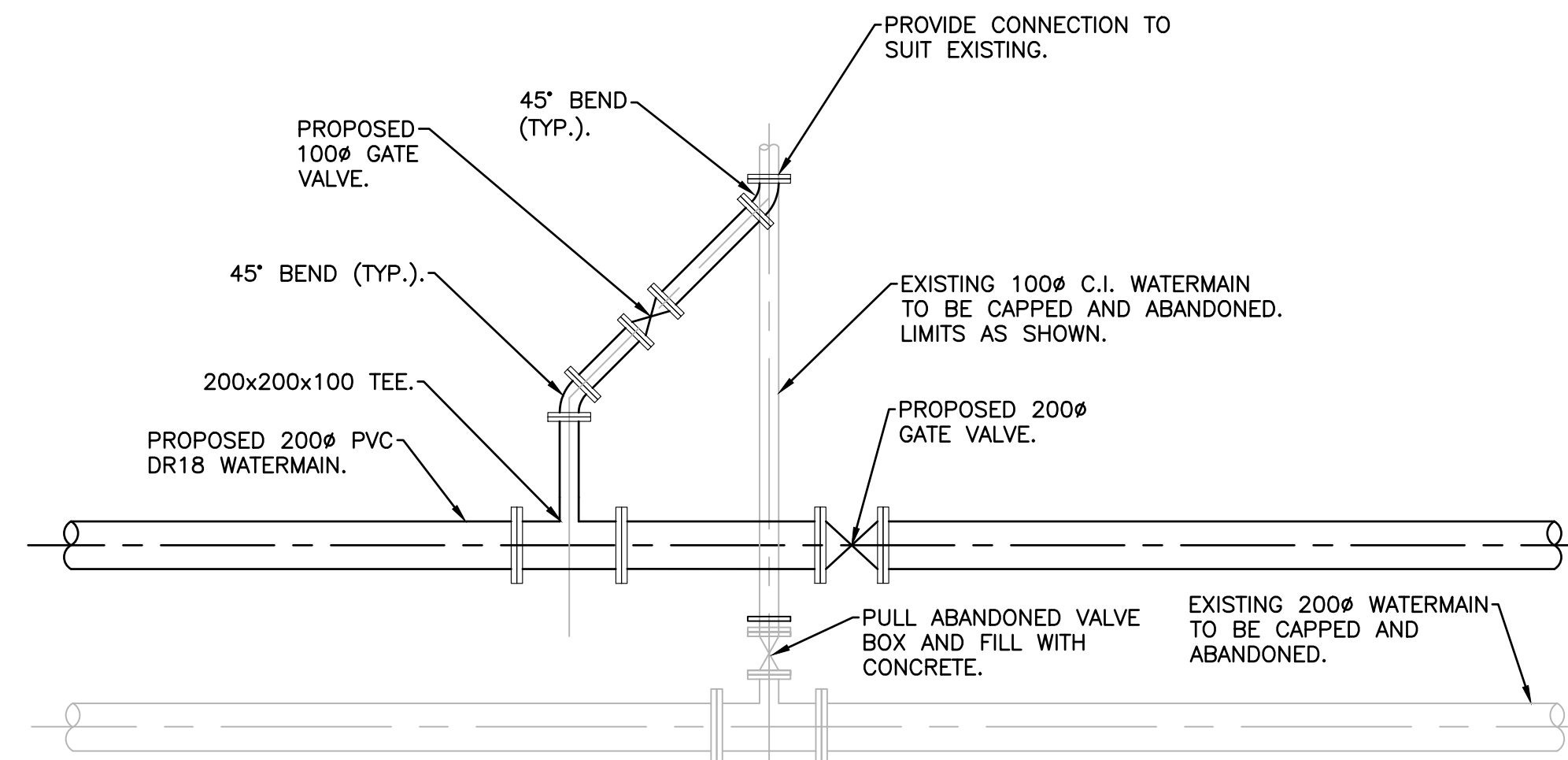

**MAIN & RIDEAU STREET CONNECTION DETAIL**  
1:25

FILENAME: C:\PROJECTS\WORKING DIRECTORIES\PROJECTS 2019\SRM\DWG\25664\2-19-2019\10-10-19-2019-CONNECTION DETAILS.DWG PLOTTED BY: WADDEN, RANDY  
 PLOT DATE: 2019-09-10 8:17:10 AM PLOT SCALE: 1:25.4 PLOT STYLE: DILLON-STANDARD.ctb

**Conditions of Use**  
 Verify elevations and/or dimensions on drawing prior to use. Report any discrepancies to Dillon Consulting Limited.  
 Do not scale dimensions from drawing.  
 Do not modify drawing, re-use it, or use it for purposes other than those intended at the time of its preparation without prior written permission from Dillon Consulting Limited.



**NOT FOR CONSTRUCTION**



NO.	ISSUED FOR	DATE	BY
1	CLIENT REVIEW	2019/09/05	KRM

DESIGN	RTW	REVIEWED BY	KRM
DRAWN	RTW	CHECKED BY	KRM
DATE	JULY 2019		
SCALE	AS NOTED		

<b>WATERMAIN INFRASTRUCTURE RENEWAL PROJECT</b>		PROJECT NO.	19-9583
<b>CONNECTION DETAILS</b>		SHEET NO.	<b>C102</b>

